



AgraStrip®

Qualitative Test Kits

for Total Aflatoxins (B1, B2, G1, G2)

Analyze total aflatoxin at 3 cutoff levels (4 ppb, 10 ppb and 20 ppb) on-site in only 5 minutes with minimal equipment.

How the test works

The AgraStrip® qualitative tests determine the presence of total aflatoxin in commodities such as corn and peanuts, among others. The qualitative test strips analyze total aflatoxin at three cutoff levels, namely 4 ppb, 10 ppb and 20 ppb.

The cutoff levels allow for an easy visual interpretation of the results after 5 minutes assay time.

Applications

A variety of commodities such as grains, grain products and peanuts can be analyzed. Please refer to current application notes for your commodity of interest.

Kit contents

Each kit includes test strips, conjugate wells, assay diluent, pipette tips, microwell holder, and (optionally) Whirl-Pak® bags to perform 24 tests.

Ordering Information

Item	Description	Cutoff Level	Item No.
AgraStrip® Aflatoxin 4 ppb	24 Tests	4 ppb	10002129
AgraStrip® Aflatoxin 4 ppb incl. Whirl-Pak® bags	24 Tests	4 ppb	10002130
AgraStrip® Aflatoxin 10 ppb	24 Tests	10 ppb	10002131
AgraStrip® Aflatoxin 10 ppb incl. Whirl-Pak® bags	24 Tests	10 ppb	10002132
AgraStrip® Aflatoxin 20 ppb	24 Tests	20 ppb	10002126
AgraStrip® Aflatoxin 20 ppb incl. Whirl-Pak® bagS	24 Tests	20 ppb	10002127



Features and Benefits

On site

- Test procedure without equipment
- Minimal materials needed
- Storage at 2 – 25 °C

Fast

- 5-minute assay
- Only two pipetting steps

Easy

- No sophisticated training necessary
- Visual interpretation of results



AgraStrip® Total Aflatoxin

Carefully read the product manual before performing any test.

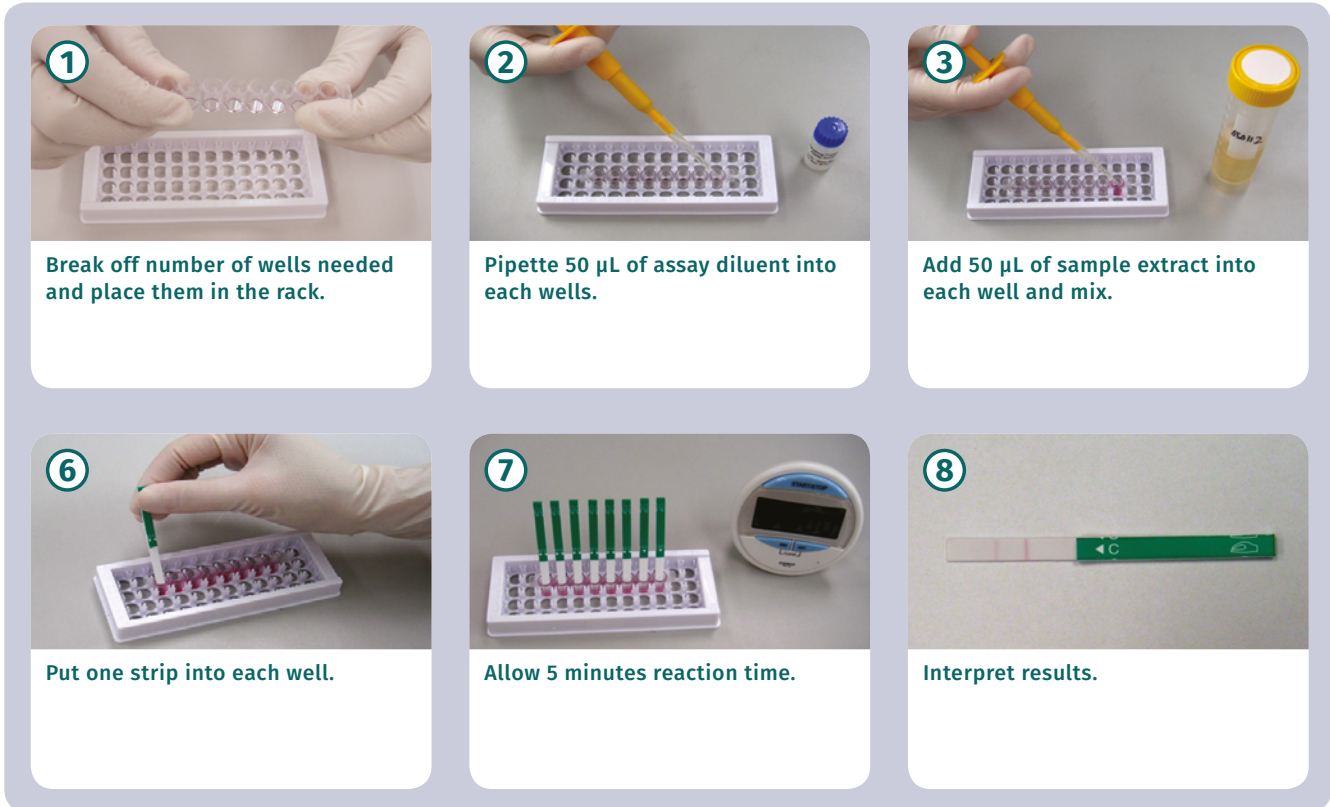

Interpretation of results

A colored line will always appear at the top of the test strip to indicate that the test strip is functioning properly. This line is the control line.

Negative: Aflatoxin less than cutoff level (two color lines)



Positive: Aflatoxin greater than or equal to the cutoff level (one control line)



Invalid results: no control line

